

Temprare solo la superficie eccentrica

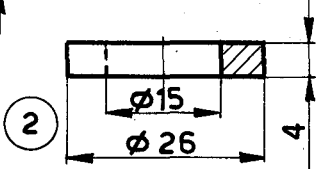
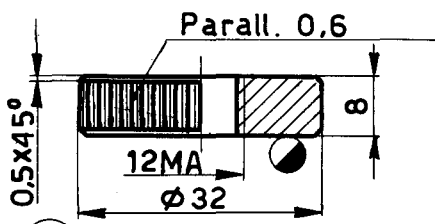
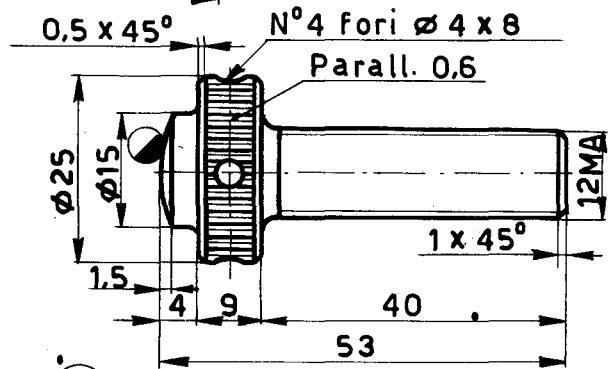
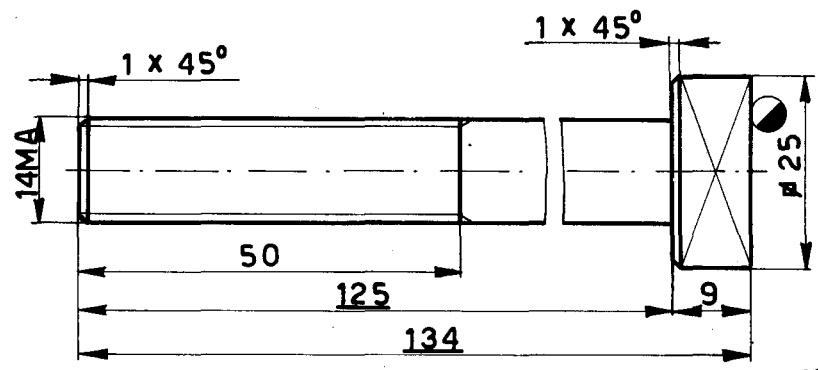

Cem. e temp. l'estr. sferica

11	DADO ZIGRINATO	1	Ø 33 x 13	12 NC 3	Bonif.
10	PUNTALINO	1	Ø 26 x 58	C 10	Cem. e temp. l'est.
8	LEVA AD ECCENTRICO	1	Ø 25 x 119	C 10	Cem. e temp. l'est.
3	VITE A TESTA QUADRA	1	Ø 36 x 140	Aq 42	
2	RONDELLA	1	Ø 28 x 8	C 30	Bonif.
POS.	DENOMINAZIONE	QUANT.	DIMENS. GREZZO	MATERIALE	NOTE

TOLLERANZE

TEMPO CONCESSO

SCALA 1:1



ESERCIZIO PROPOSTO DA